



COMMUNITY NEWSLETTER

www.mimi.school.co.nz

July 2016

Schools are amazing places ...

... and Mimi School is no different. It's one of the few places in New Zealand where children from different life experiences, beliefs, interests, families and view on the world can come together day after day to learn about each other and from each other. At Mimi School we have a set of common values that helps us to learn in a positive environment together. These are aspirational values but I believe they are worth reaching for the stars for. Let me remind you of what they are:

1. Manage ourselves with integrity, which involves being honest, respectful, and sincere independently of others, even when no one is watching.
2. Relating to others with empathy, which involves being fair, patient, and kind, trustworthy and forgiving.
3. Participating and contributing for the common good, which involves being persistent, curious, creative, innovative, enthusiastic and being willing to take responsible risks.

My wish is that we help each to make these values more and more imbedded in everything we do as we come together as the Mimi School community.

This term saw fourteen of our year six students attend the National Young Leaders Day in Rotorua. The day is for year six to eight students from around the central North Island. It is an opportunity for the students to come together, to be encouraged and motivated by different speakers as they shared some of their life stories and how they overcame the barriers in their lives.

Before coming back the students spent time on the luge which was a great way to finish the day. The day is one way we say thank you to our year six's for being great role models in our school. Thank you to the Home and School for having funds available for the students to do this.



MIMI SCHOOL



where the country, coast, and classroom meet

Produced and published by Mimi School,
23 Pukearuhe Road, RD 44, Urenui, Phone: 06 75 23617
Email: admin@mimi.school.nz

The parent teacher interviews are a formal and very important event in the school calendar. This year every child had a parent or more come to this sharing time which was held at the end of May. Thank you for taking the time to meet with your child's teacher. We value the time we have with your child at school and we like to share what we know of your child with you.

The Board of Trustee elections were held this term. We had a high percentage of the eligible parents' vote which was very pleasing. At the first meeting Donna Ellis was elected the new chairperson. On the board with Donna now are Davis McClutchie, Neil Davy, Andrew Brendon, Sarah Blyde, and Nicky McDonald. A big thank you goes out to Maire Gill who is our outgoing chairperson who has spent over six years as a member of the Mimi School Board of Trustees. Your care and passion for the school is admired. I wish to thank Lisa McClutchie for her involvement on the board too. Lisa did not seek to be re-elected but I know we will continue to see her around the school on a daily basis. We value that.

The big fundraiser for the school this term was the Quiz Night. A small team of parents worked together to make this evening a very successful one. The hall was full, the food was great, and the questions were varied. The success of the evening was also due to the support from the wider Mimi School community through the purchasing of the tickets, the forming of the teams and adding to the positive atmosphere on the night.

As we look to term three, which is the shortest of the four terms, there is a range of events planned for all of us to be involved in. We have hockey coaching for the whole school, the Life Education classroom will be on site, school photos will be taken, the Tainui Cluster Cross Country will be held at Mimi School and towards the end of the term we will have our Pet Day.

I want to finish this piece of the newsletter with a piece of information that I found interesting. My hope is that you do, too.

A Growth Mind Set versus a Fixed Mind Set.

A growth mind set is the belief that intelligence and smartness can be learned and that the brain grows from experience and effort. The opposite, a fixed mind set is the idea that you are smart, or you are not. In maths, that translates into 'some people are good at maths and some are not.'

Did you know that praising efforts rather than intelligence or results can impact your child's ability to persevere in challenges? The goal is to have children thrive on challenges and see failures, not as a sign of low intelligence but as a learning opportunity. Brain research tells us that making mistakes actually wires more connections into the brain. When a person has a growth mind set they accept challenges, see their efforts as worthwhile and are open to learning from mistakes. Students with a growth mind set achieve at higher levels than those with fixed mind sets.

How can you help?

1. Adding 'yet' when they claim they are 'not good at this' (Respond: "You are not good at this yet")
2. Ask questions that focus on their effort and choices and get them to reflect on satisfaction of that effort e.g. What did you try hard at today?

I look forward to seeing you all some time during term three.

*Regards,
Andrew Birchler
Principal*

RuralSupport

The Taranaki Rural Support Trust invites you to a "GOOD YARN". Learn how to recognise and respond appropriately to friends, family or farming colleagues experiencing stress or mental illness. **Wednesday, 10th August, 10:00am - 2:00pm** Urenui Community Hall.

This is a free workshop with lunch provided. Register by emailing trst@outlook.co.nz or phone Marcia Paurini 0274 627242

Earthworks Rural and Residential

- Diggers, 1, 6, 12 tonne ■ Dozers, 4, 16 tonne ■ 18 in. tree chipper
- Portable saw mill ■ Trucks ■ Bobcat



GT Earthworks

Ph: 0210 294 8984



Kiwi Class Courier

Weekdays \$1.60 Saturday \$2.00

Established in Mimi 2016

CHOO! CHOO!

Man with train visits school

Reporter Sheldon Fawkner

On Friday afternoon on the 24th of June Mr Davy came into Mimi School to show his model trains to the Kiwi Room. The class got to drive a train and there were accidents. There were Steam Trains and Passenger Trains. Kiwi class cant wait to visit Mr Davy' s place because they want to see all his trains in his train room.

Reporter Tane Smith

On Friday 24 June Mr Neil Davy brought his beautiful model train in to show Mimi School. Everyone got one turn driving the train. No one got two turns. There were some derailments because the trains were going too



Children enjoying the model train set bought in by Luke and Joshua's dad, Neil Davy.

fast on the corners. The highest speed was one hundred and that was the best speed.

Reporter Amy Honeyfield

On Friday Neil Davy came to Mimi School so Kiwi Room could see a bit of his model train set. There were heaps of carriages and a Passenger Train and a model Steam Train. The class all had a turn at driving the trains. The speed went up to

100. The class made model trees as well.



There were lots of derailments and lots of loads on the carriages. Derailments were caused by going too fast.

Tom Bower Reporter

Kokako Squad

Yr 4 & 5 & 6



Rippa Rugby Tournament

At Clifton rugby ground we played some awesome games of rippa against some rural school teams. Both of the teams won some games and overall we had a great time without too many sore muscles.



Exploration Hour

This term we have had some awesome exploration hour activities with some parents and community coming in to share their skills. We were lucky enough to do golf, cooking, building, dream catchers, and lots more. We can't wait for next terms exploration hour.

A special THANKYOU to our community members for coming in and showing us new things.



Chapter Chat

Some of us have been reading the book Winn Dixie by Kate Dicamillo. On Friday we get to chat with other classes around New Zealand. We get to present things like a model of a dog house and movie trailers. We've made them to try to show how good the book is. It's a great read. I really think you should pick it up and have a go. By Corbyn Ape-Eserra

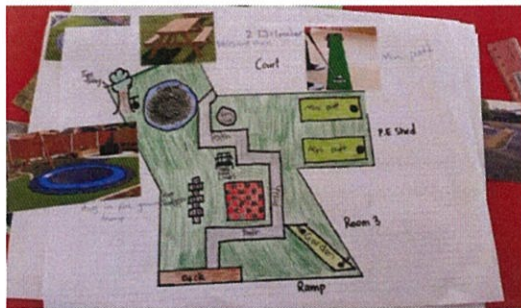

Watch THIS SPACE....

We are designing the front our new classroom....will the Board of Trustees approve... golf courses, trapezes, In the ground tramp, imagination playground, outdoor classroom, foam pits, work benches, table gardens... trapezes???

Young Leaders 2016



"Believe to achieve"

"Don't say can't, say I'll try"

"Elevators are like people, they can take you up or down"

"Don't think about the negatives, think about what you have and be thankful"

"Do the right thing, even if you want to do the left thing"

CALLING ALL YEAR 6's...

This term the Year 6 leaders travelled to the Young Leaders conference in Rotorua. We meet and listened to some inspirational speakers who inspired us to be great leaders in our school and community. To top the day off we had a blast racing down the luge tracks.



Communication Leadership
Management Creativity
Teamwork Organization
Motivated Innovative



Hello Community,

Great to get my first opportunity to write a brief message as the new Chairperson at Mimi School.

I would firstly like to say a big thank you to Maire Gill, our previous Chairperson, for her hard work and dedication to the school and the community. Maire has given a significant amount of her time to continuously make our school a better place for our children, and I personally feel she has performed admirably in this role. Thanks Maire, for a job well done.

Expressions of Interest

Mimi School is starting to plan for the 2017 school year. We are seeking individuals over the age of 18 who would be interested in being a Teacher Aide at Mimi School.

We are looking for individuals who are reliable, have empathy for the needs of students, are willing to learn new skills, are flexible in their thinking and willing to work closely with classroom teachers, and are self-motivated.

Please note: There is no actual position at the moment but I would like to start a conversation with you if you are interested.

Please contact me at the school office.

Andrew Birchler

Well, another fantastic term for our great school has come to a close. As always we had so many achievements throughout the term, and we look forward to those continuing both inside and outside the classroom.

Student achievement is such an important aspect for our school. I feel we always punch above our weight, and whilst there are many aspects that contribute toward this, I would like to make a very special mention of our staff. They are absolutely fundamental to our school's success. Whilst not all live within our community environment, through their contribution to the school and our children, they are such a big part of our community. Well done staff members and thanks for your continued efforts at Mimi School.

We like to think that the school is the centre of our community, so on behalf of Mimi School I would like to say a big welcome to all of the new families to our community.

Please pop into our school at any time and have a look at our fantastic facilities and look forward to seeing you at upcoming school events such as Pet Day and Cross Country.

Donna Ellis
Chairperson
Board of Trustees

Tainui Group Day AGM Thursday, 4th August 7:30pm Ahititi Multi Purpose Room

Paul Jones will be stepping down as President.

Tainui Group Day will be in its 84th year this year and its a great day for kids to collect ribbons, sashes, show off their pets, generally have a great day out.

Free Lunch.

We had fantastic help from all cluster parents in 2015, we do need people at this meeting and someone to take on President please. If this day is to continue, we need help from other cluster parents

Mimi School Pet Day

Thur 22 Sept From 10:00 am

"Can we drag you there?"



Mimi's Minis Playgroup

Playgroup for
under 5's

\$2 entry per family
Morning tea provided for adults
Please bring morning tea for
your children

Fridays
(during term)
9am - 12pm

Waitaiti Hall,
Pukearuhe Rd

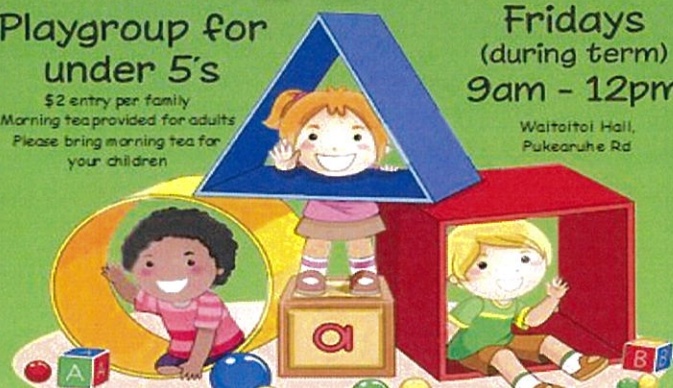

Amanda's mobile beauty therapy

All aspects of beauty in the
comfort of your own home or
at my salon in Waitara!

Gift vouchers available.

Brochures available at the
school office.

Phone: 021 500 499



TERM 3 CALENDAR

TERM 3 STARTS Mon 25 July

HOCKEY Tue 26 July

SCHOOL PHOTOS Fri 5 Aug

HOME&SCHOOL MEETING Mon 8 Aug

LIFE EDUCATION Tue 9 -
Wed 10 Aug

BOARD OF TRUSTEES MEET Thur 11 Aug

LEAD CONFERENCE (Yr 6) Fri 19 Aug

HOCKEY Tue 23 -
Wed 24 Aug

CROSS COUNTRY Fri 2 Sept

FATHER'S DAY Sun 4 Sept

*MANUKORIHI ORIENTATION Fri 16 Sept

MIMI PET DAY Thur 22 Sept

END OF TERM 3 Fri 23 Sept

DAYLIGHT SAVINGS BEGINS Sun 25 Sept

* Trips out of school grounds,
(transport may be needed)

Please contact Andrew or Sibylle at school for
further information.

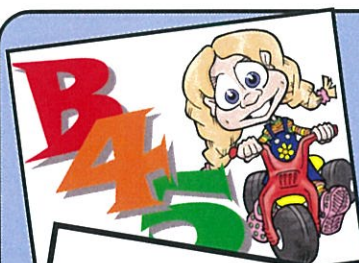

9am-
11am
Fridays

Our weekly pre-school sessions run
on Fridays each week. These ses-
sions are focused on developing the
early skills that our children need to
develop sound literacy and numeracy
skills.

They are also intended to be a lot of
fun for you and your kids as they
become familiar with the class-
room and classroom routines.

If you want to know more about our
B45 pre-school programme phone
the school office, or drop in and ask.

Pukekohe Domain
Cnr Cracroft & Cameron Street
Waitara
www.waitaragymsports.co.nz
Ph 06 754 8292
Hayley Jury - Mobile 027 867 1806



Come along and give gymnastic a go. We have classes for beginners to experienced gymnasts.

Our classes are on Monday through to Saturday, have a look at the website above and you can find a time suitable for you or call the numbers listed above and we can help you.

We have fun filled classes with fully qualified coaches. We do incentive award badge work, have mini competition in the classes and treat each gymnast as an individual.

Gymnastics teaches many things; co-ordination, fitness, strength, flexibility, how to work together as a team and how to have fun.

Come along and check us out at the above address, if you are keen we can enroll you in a class that suits your ability so you feel right at home.

ACTION
INDOOR SPORTS STADIUMS

INDOOR NETBALL LEAGUES
STARTING NOW

*"great practice
for your outdoor
netball team"*

*Sunday Monday
Tuesday Wednesday
Thursday Evenings
ALL GRADES*

ENTER ONLINE @ www.actionindoorsports.com

New Plymouth Girls' High School – Netball Clinic Wednesday 20 July 2016

Held at New Plymouth Girls' High School. Netball drills/games and other fun games will be the focus for ages 7-12.

Session time: am: 9 – 1 pm
(includes registration) Cost: \$15
Concession of \$25 for family of two

Please bring: own snack food (morning tea), drink bottle, sweat towel (optional), sweater.

Send your entries to:
Josie Cleaver
NPGHS
Private Bag 2049
New Plymouth or
Email: jcleaver@npghs.school.nz

Waitara Basketball Camp Friday 15th July 2016

10am—2:30 pm \$10 for the day

Top level coaches in Taranaki will be taking players through skill stations, modified basketball games and much more.

Players aged from 9-11 years and of all abilities welcome.

To register email vanessa.mccarthy@sporttaranaki.org.nz

Basketball Skills Clinic 30th July 2016 Inglewood High School Gym

Session One: Age 6-8 years 9am-12pm \$35

Session Two: Age 9-12 years, 2pm—5pm \$35

Limited spaces

Text/call 1027 585 8593 or email josh@championshipsports.co.nz